



R55i (Gray Plate) Installation Details

for Optimal Performance

PRESSURE:
15-40 PSI
(1-2.75 BAR)

NOZZLES:
#52-#80

**(DO NOT USE
#90 BLUE
NOZZLE!)**

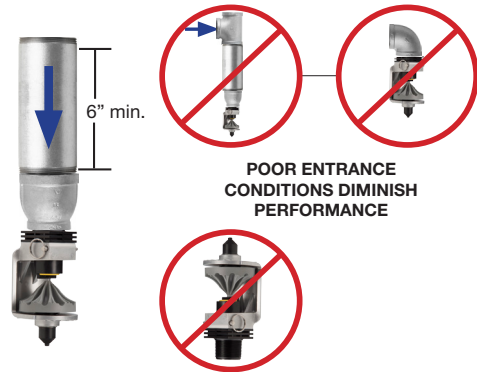
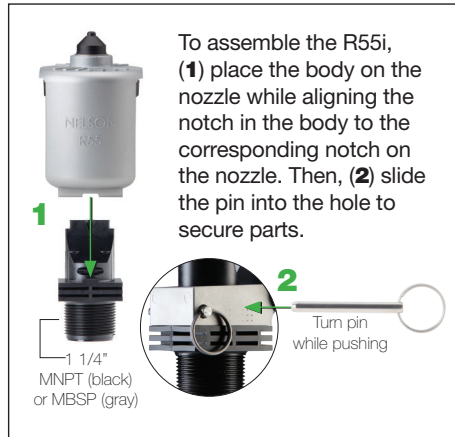

R55i (GRAY PLATE) PERFORMANCE

U.S. UNITS

Pressure (psi)	#52 Purple Nozzle		#60 Red Nozzle		#70 Yellow Nozzle		#80 Green Nozzle	
	Flow (gpm)	Radius (ft)	Flow (gpm)	Radius (ft)	Flow (gpm)	Radius (ft)	Flow (gpm)	Radius (ft)
15	18.3	39	27.7	37	36.6	36	45.2	35
20	20.9	41	31.8	40	41.8	39	51.7	38
25	23.4	43	35.5	42	46.7	41	57.7	40
30	25.8	45	38.9	44	51.1	43	63.1	42
35	27.9	46	42.1	45	55.1	44	68.2	43
40	30.0	47	44.9	46	58.8	44	72.7	43

METRIC UNITS

Pressure (bar)	#52 Purple Nozzle		#60 Red Nozzle		#70 Yellow Nozzle		#80 Green Nozzle	
	Flow (m ³ /hr)	Radius (m)	Flow (m ³ /hr)	Radius (m)	Flow (m ³ /hr)	Radius (m)	Flow (m ³ /hr)	Radius (m)
1.00	4.1	11.8	6.2	11.2	8.2	10.9	10.1	10.6
1.50	5.0	12.8	7.5	12.4	9.9	12.1	12.2	11.8
2.00	5.7	13.5	8.7	13.3	11.4	12.9	14.1	12.6
2.50	6.5	14.1	9.7	13.8	12.7	13.3	15.7	13.0
2.75	6.8	14.3	10.2	14.0	13.3	13.4	16.5	13.1

R55i performance data has been obtained under ideal test conditions and may be adversely affected by wind, poor hydraulic entrance conditions or other factors. Test riser height of 9 feet (2.7 meters) above measurement surface. No representation regarding droplet condition, uniformity, application rate, or suitability for a particular application is made herein.

WARRANTY AND DISCLAIMER: Nelson R55i Sprinklers are warranted for one year from date of original sale to be free of defective materials and workmanship when used within the working specifications for which the products were designed and under normal use and service. The manufacturer assumes no responsibility for installation, removal or unauthorized repair of defective parts. The manufacturer's liability under this warranty is limited solely to replacement or repair of defective parts and the manufacturer will not be liable for any crop or other consequential damages resulting from defects or breach of warranty. THIS WARRANTY IS EXPRESSLY IN LIEU OF ALL OTHER WARRANTIES, EXPRESS OR IMPLIED, INCLUDING THE WARRANTIES OF MERCHANTABILITY AND FITNESS FOR PARTICULAR PURPOSES AND OF ALL OTHER OBLIGATIONS OR LIABILITIES OF MANUFACTURER. No agent, employee or representative of the manufacturer has authority to waive, alter or add to the provisions of this warranty, nor to make any representations or warranty not contained herein.



Nelson Irrigation Corporation
 848 Airport Road, Walla Walla, WA 99362 U.S.A.
 Tel: 509.525.7660 — nelsonirrigation.com