

Technical data

T3K80/2E-TW [3000 1/min]

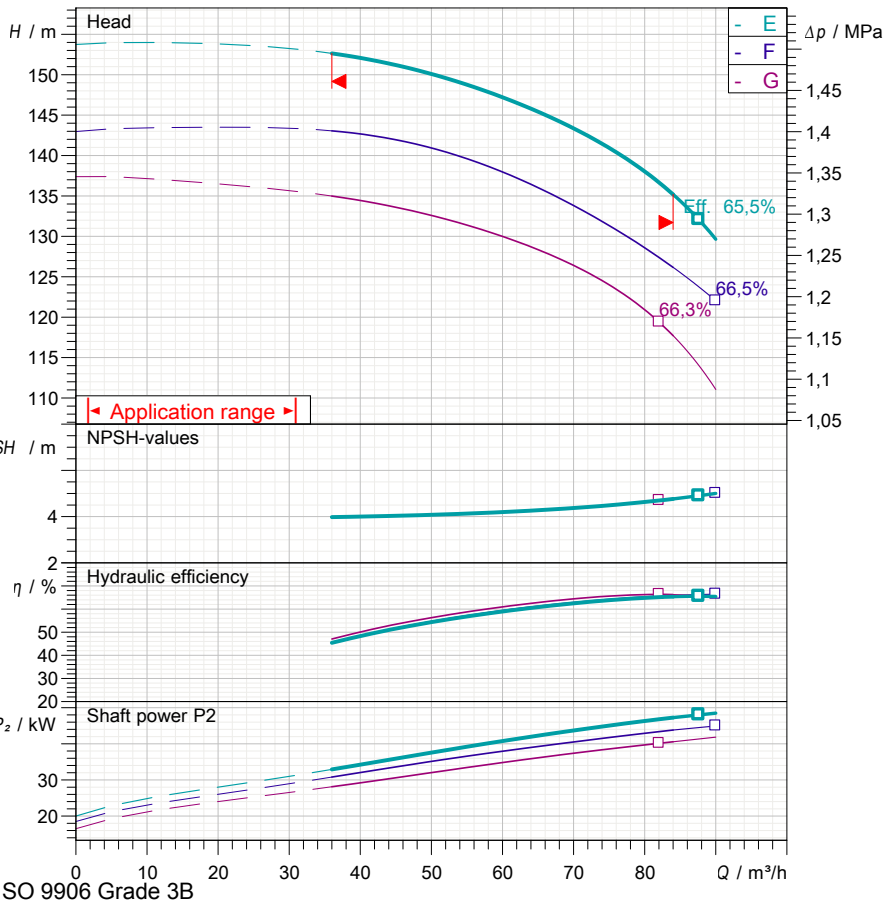

Operating data specification

Capacity	
Head	
Fluid	Pure water
Type of installation	<Single head pump>

Pump operating data

Design	T3K80/2E-TW [3000 1/min]
Impeller Ø	
Speed	3000 1/min
Flow	
Head	
Shaft power P2	
Efficiency	
Head (Q=0)	154 m
Non return valve loss	

Coupling

Gear ratio	5,85
PTO	510 1/min
Trolley	CT.3K
Cardan shaft	R 600/80
Three-point mounting	

Use limits

Max N° startings/hour	
Max. runing time with Q=0	2 min
Max. solids contents	40 g/m³
Max. pumped liquid temperature	60 °C
Maximum density	998 kg/m³
Maximum viscosity	1 mm²/s

Materials

Gear box	Cast iron
PTO shaft	Case hardened steel
PTO transmission gear	Case hardened steel
Shaft pinion	Case hardened steel
Wear ring	Cast iron
Suction bowl	Cast iron
Impeller	Cast iron
Pump body	Cast iron
Twiner system®	Stainless steel
Stuffing-box packing	PTFE

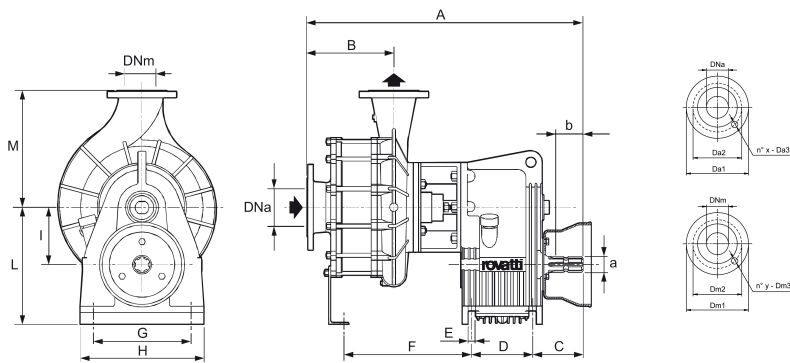

Dimensions in				mm		Total weight		99 kg	
DNa	80	G	240	Da2	160				
DNm	65	H	270	Da3	18				
A	599	I	130	x	8				
B	195	L	254	Dm1	185				
C	111	M	260	Dm2	145				
D	130	a	1"3/8	Dm3	18				
E	15	b	60	y	8				
F	266	Da1	200						

Performance curves

T3K80/2E-TW [3000 1/min]

Performances		Speed	3000 1/min	Density	998 kg/m ³
Flow	Min.	36 m ³ /h	Viscosity	1 mm ² /s	
	Max.	84 m ³ /h	Temperature	20 °C	
Efficiency	Max.	87,6 m ³ /h	Tolerances	ISO 9906 Grade 3B	

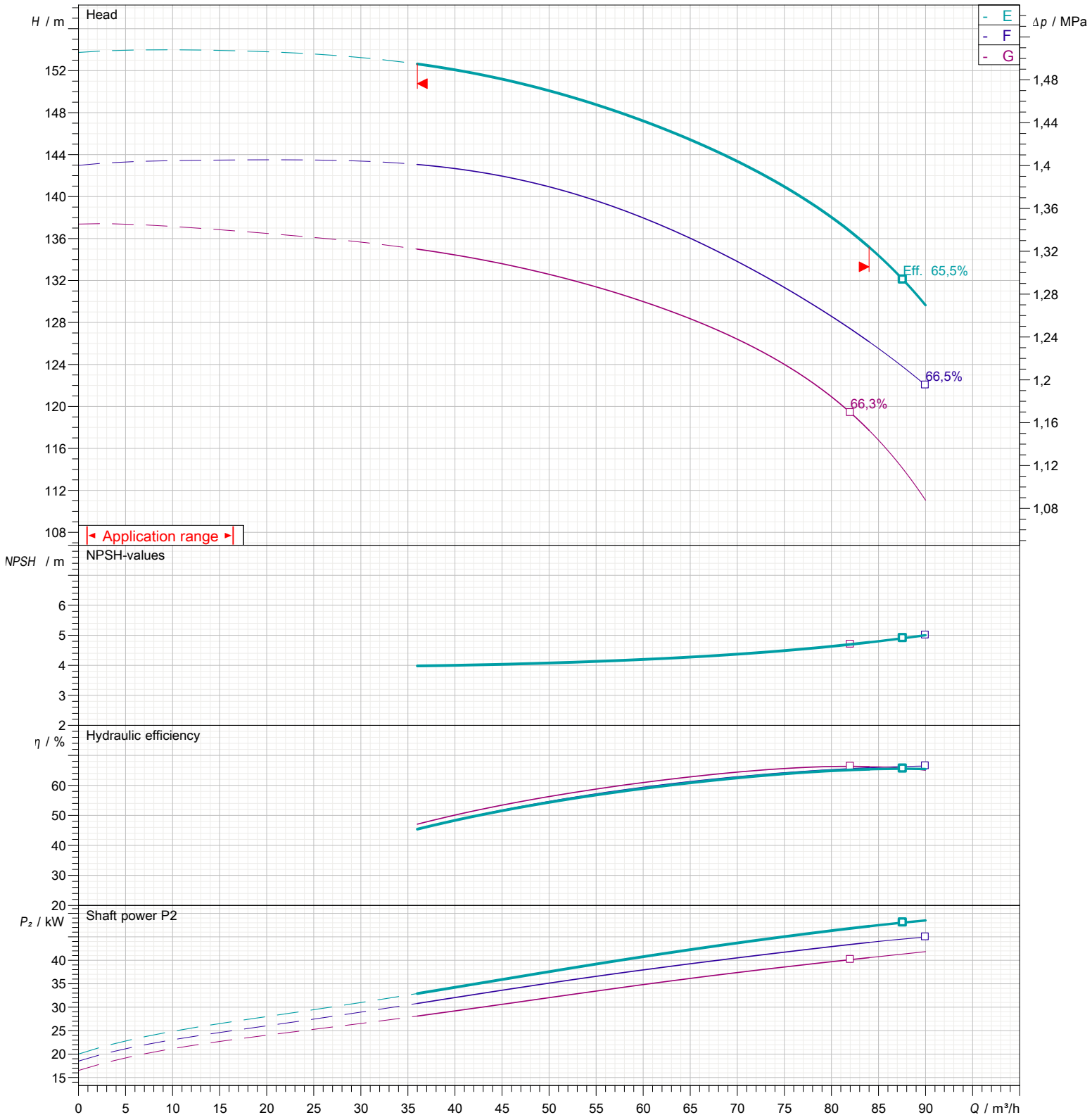

Types of installation

T3K80/2E-TW [3000 1/min]

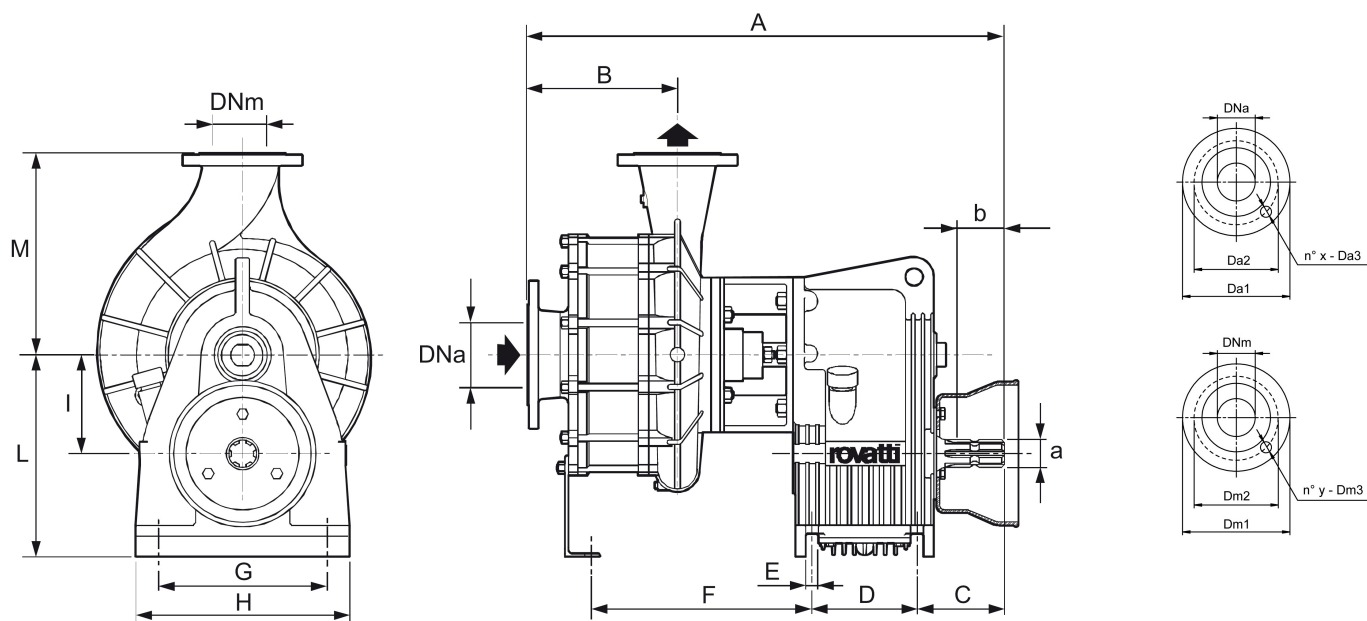

Dimensions in		mm	Total weight	99 kg
DNa	80	Dm3	18	
DNm	65	y	8	
A	599			
B	195			
C	111			
D	130			
E	15			
F	266			
G	240			
H	270			
I	130			
L	254			
M	260			
a	1"3/8			
b	60			
Da1	200			
Da2	160			
Da3	18			
x	8			
Dm1	185			
Dm2	145			